

The Experience

Q Panel General Guide

Contents

Q Panel General Guide

Welcome to Q Experience!
Available applications
Tech overview

Overview

Quick Start

Applications

Elements: Sidebar

Sidebar: Modes

Elements: Main menu

Applications: Map

Map: Opening Radar & Fishfinder

Applications: Radar & Fishfinder

Applications: Dashboard

Applications: Radio

Applications: Weather

Applications: Guides

Applications: Settings

Applications: Boat Heater

Applications: Boat Controls

Welcome to Q Experience!

The Q Experience is a smart navigation system. It updates the boating experience to the modern day by combining boat's functions into one big touch screen: Q Panel that can be directly installed in any boat model.

System's IoT capabilities make boating easier and safer than ever. For example, Q Panel gives maintenance recommendations based on information from boat's engine. It can also save your favorite routes that you can then upload to cloud.

Available Applications

- Map with Fishfinder & Radar
- Dashboard
- Boat Controls
- Weather
- Documents & Guides
- FM & DAB Radio
- Boat Heater by Wallas

Tech Overview

- 10 + 16 inch screen sizes
- polarized, waterproof screen
- NMEA2000 compatibility
- Bluetooth
- WiFi & hotspot
- 2 CAN buses
- solid protective case

Overview

You'll find more instructions and troubleshooting material on Q system's homepage www.theQexperience.com or by following The Q Experience on Youtube.

Sidebar contains important boating information, e.g. rpm and speed. If the boat has a sounder attached, top part of the sidebar displays sounder data.

You can switch modes and access their functions by using **mode controls** in sidebar's lower part. Same controls can be found on the Q Remote if you have one.

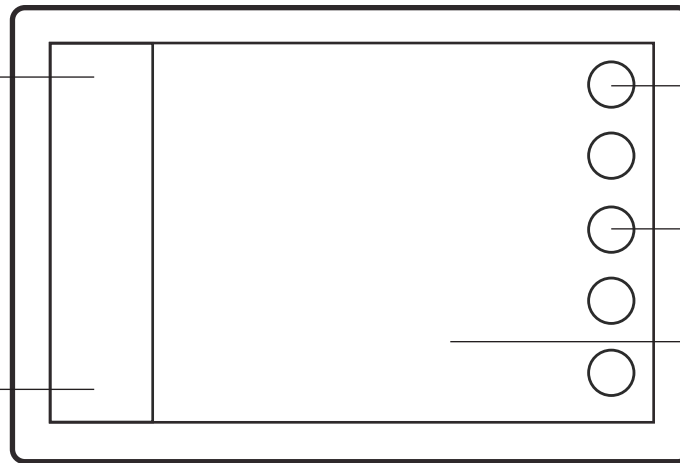

The soft key for **main menu** can be found in the top right corner. Applications and settings can be accessed here.

Other keys are **function keys**. Their number and function depend on the active application.

Applications such as Map, Dashboard and Radio open in the **application area**.

Quick Start

Tip: By default Q system shuts down when you turn off the engine. To continue use, just tap on screen during the shutdown process.

1 Q system starts up when you turn the ignition key.

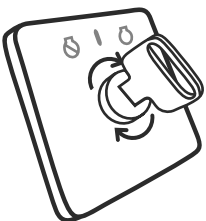

2 First the system runs a quick check-up.

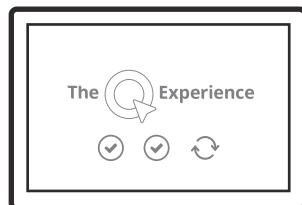

3 Accept disclaimer to start navigation.

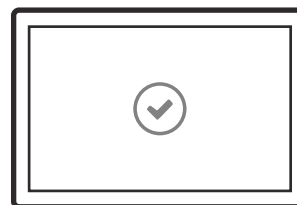

4 Navigation will start automatically.

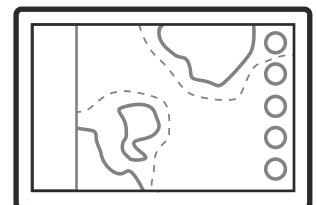

5 Access menu for more applications and settings. Have fun!

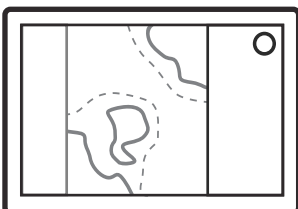

Applications:



Map



Dashboard



Radio



Weather



Settings



Guides



Heater

Elements: Sidebar

1 Signal icons

Icons are located at the top. They indicate the strength of WiFi, GPS and other signals.



2 Sounder

Sounder field displays sounder data at the top. Tap on the field to view history.

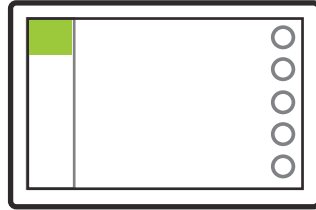

3 Motor data

Sidebar's middle part displays engine data. Tap on the field to open dashboard.



4 Modes

Mode controls are located in the bottom part. Change mode by tapping on the colored icon.

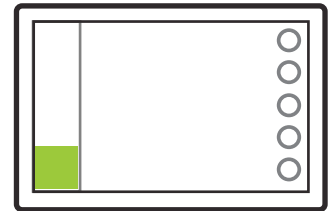

Sidebar: Modes

Mode controls are handy shortcuts to system's important functions. The number of modes you can use depends on which extra packages or appliances you have in your boat.

Q Remote has the same controls as sidebar. Fasten the remote onto your steering wheel and you can use the system with both hands on the wheel.

Navigation mode

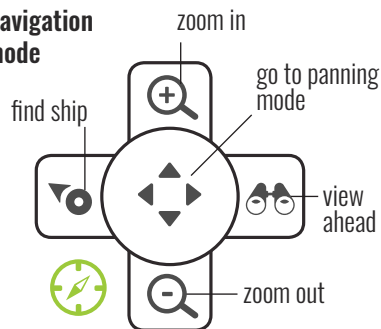

Navigation mode can be found in all devices. It contains basic navigation controls, e.g. zoom.

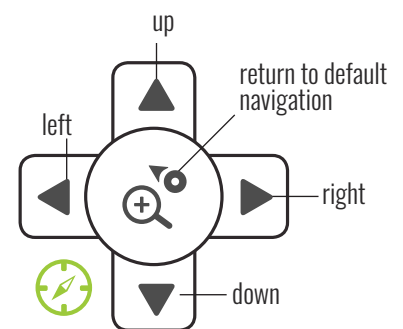

You can switch between default and panning navigation mode by pressing the center key.

Trolling mode

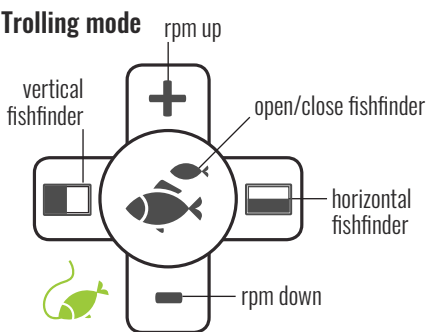

Trolling mode is available when the boat has a trolling cable connected. You can also open fishfinder (if installed) using trolling mode controls.

Media mode

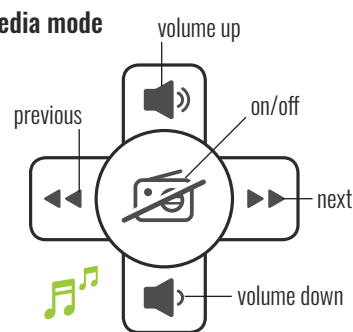

Media mode is available when the boat has a media package installed. This mode allows you to control music from the radio or Bluetooth.

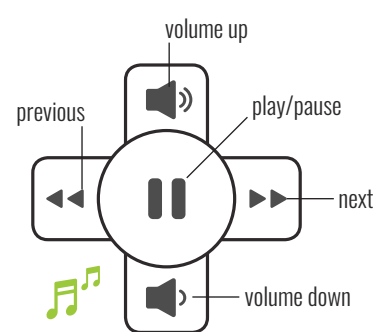

When you stream music from a Bluetooth paired device, media mode controls switch through audio tracks instead of radio channels.

Elements: Main menu

Tip: Apply a long press on menu key to open a shortcut to your default application (usually the Map) from other applications.

1 Applications

When you open the menu you'll find a list of applications that are available on your boat.

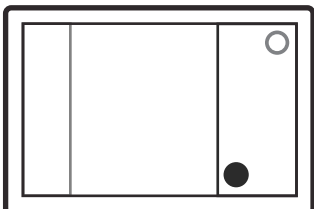

2 Quick Settings

Menu panel's second tab contains quick settings such as display brightness.

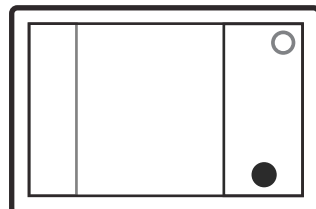

3 Closing menu panel

You can close the panel either by pressing the menu key again or tapping outside the panel.

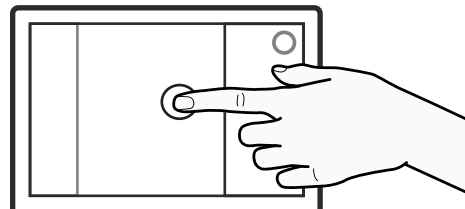

Applications: Map

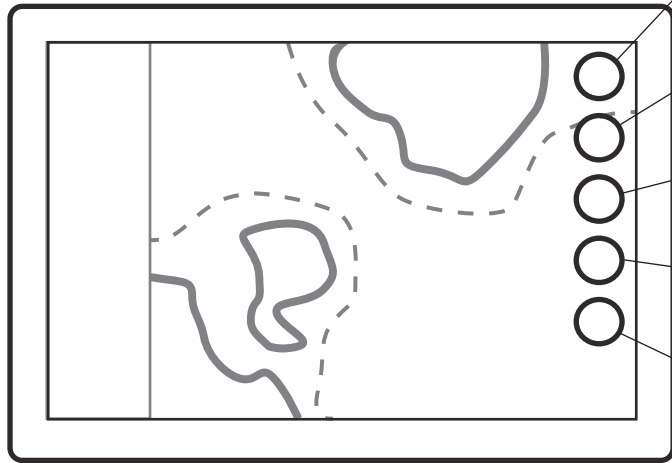

- Menu**
 - opens main menu,
 - long press is a shortcut to default application from other apps
- Zoom in**
 - zooms the map in,
 - apply long press for a quick zoom
- Zoom out**
 - zooms the map out,
 - apply long press for a quick zoom
- Find ship**
 - returns the view to boat and locks the view to its location
 - long press zooms to boat
- My Routes & Places**
 - opens route and place related functions
 - long press opens boat information

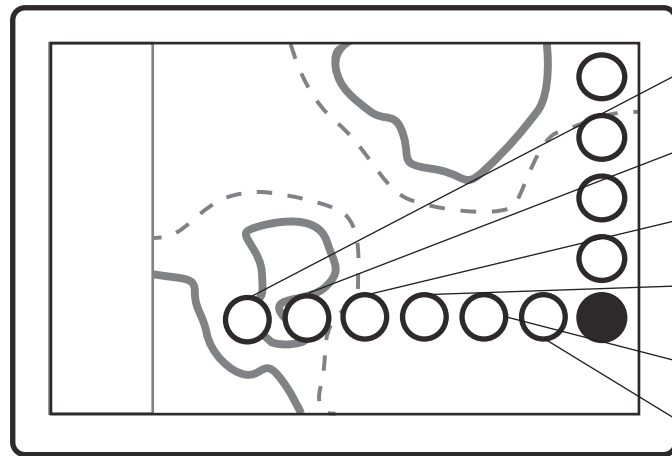

- Man Overboard**
 - adds a marker to boat's location
- Find Place**
 - opens a search for places
- My Routes**
 - opens My Routes
- My Places**
 - opens My Places
- Logbook**
 - opens a list of trips
- Trail Route**
 - records boat's route

Tip: You can change map's orientation by tapping on the north icon. Icon's arrow always points to the north.

1 Moving the map

Drag the map to any direction with one or two fingertips.

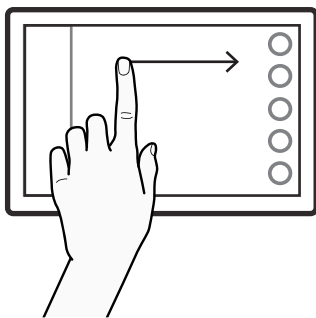

2 Zooming

Spread or pinch your fingers to zoom. You can also use the function keys on the right.

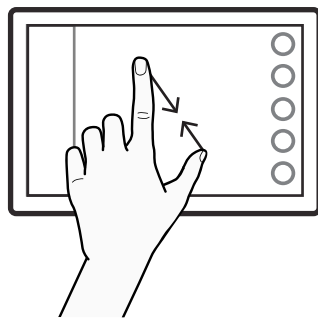

3 Measuring distances

Place your fingertips to the start and the end of the distance you want to measure.

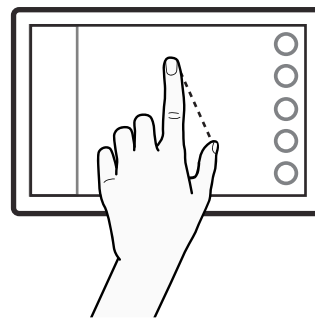

4 Position information

Tap on any point on screen to view its coordinates and other position information.

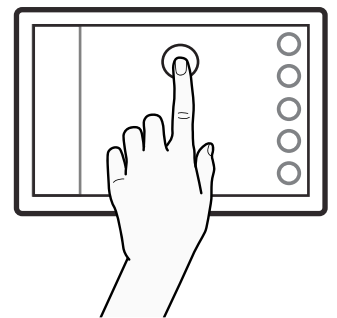

Map: Opening Radar & Fishfinder

If your boat has a fishfinder or radar installed, you'll find their apps within the Map application. By tapping on the icons you can bring out all Fishfinder or Radar functions on a separate dialogue.

1 Tap on either icon at the top of the screen.

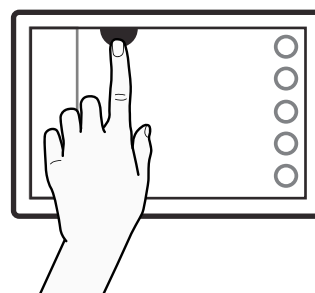

2 App's dialogue slides open over the map.

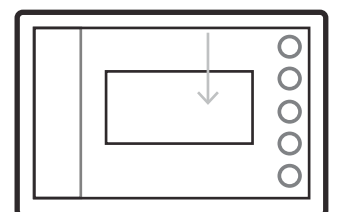

Fishfinder

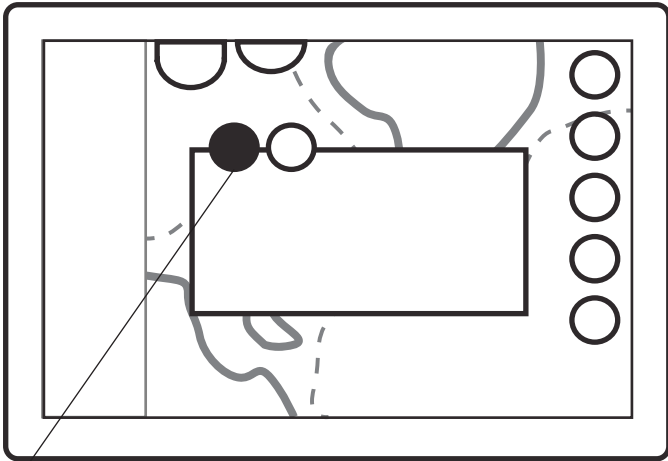

Screen options:

Close
 Corner
 Vertical
 Horizontal
 Full screen

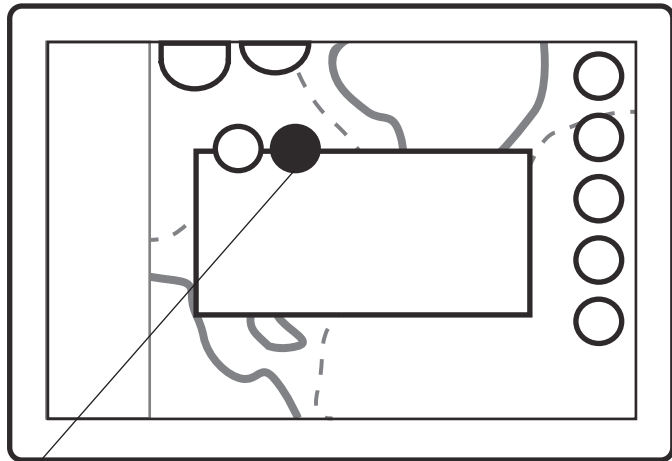

Adjustments:

Second tab has Gain, Filter, Smoothing and Speed adjustments.

Q Experience is compatible with Raymarine's super sharp fishfinder and Quantum Radar. For more information on their qualities, visit www.raymarine.com or check Q Experience's YouTube channel for video tutorials.

Radar

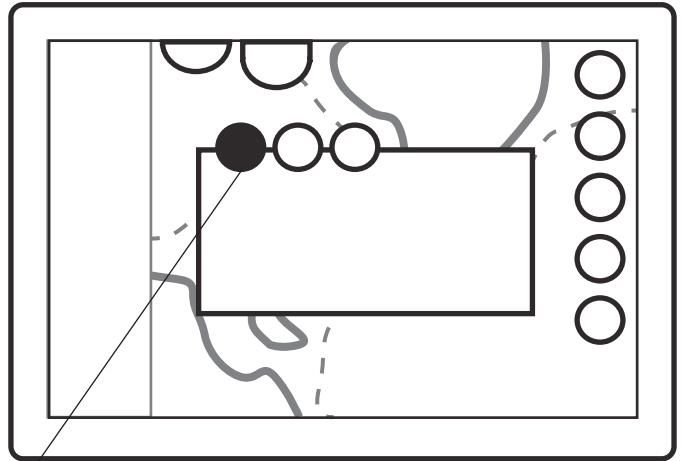

Screen options:

Close
 Corner
 Vertical
 Horizontal
 Full screen

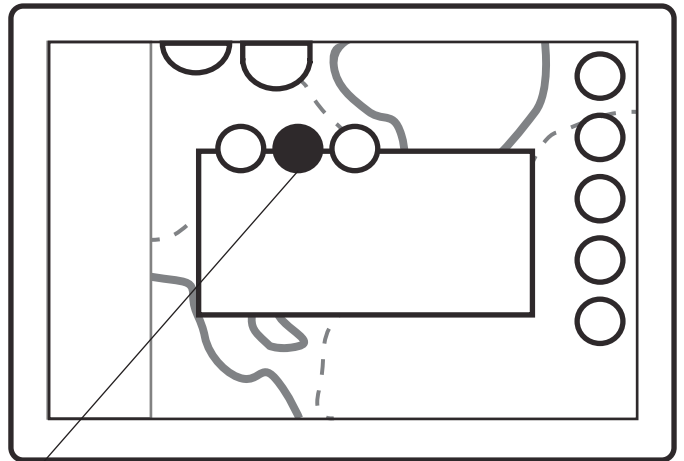

Adjustments:

Radar has adjustments for Gain, Color gain, Seaclutter and Rain clutter. Adjustments tab also has the following presets:

Harbor
 Coastal
 Offshore
 Weather

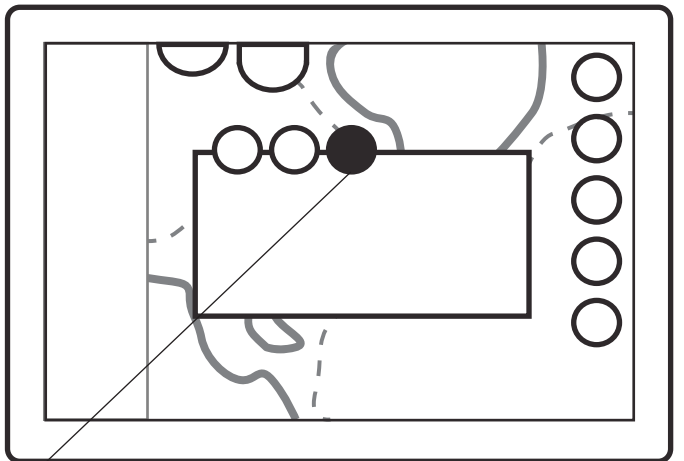



Settings:

Settings tab has options for TX Active, Overlay, Range and Save demo.

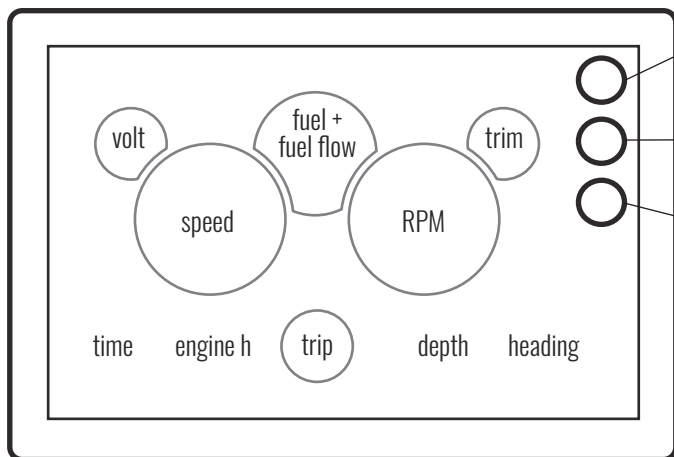
Applications: Dashboard







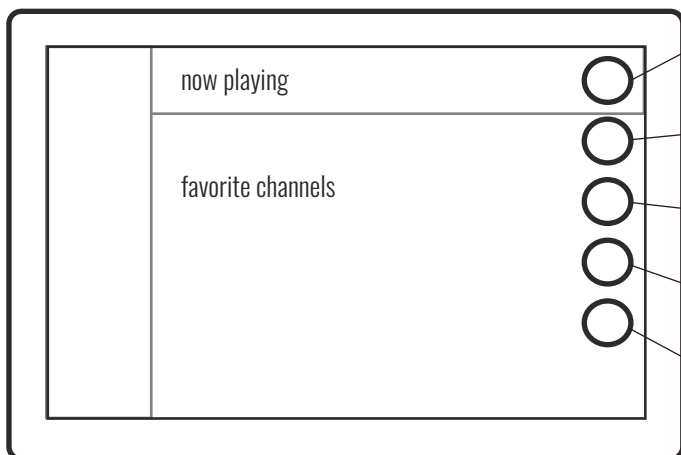

-  **Menu**
 - opens main menu,
 - long press is a shortcut to default application from other apps
-  **Map shortcut**
 - opens Map application
-  **Second page**
 - opens detailed engine data

Dashboard displays boat's main engine gauges. Access the second page to view more detailed engine data.

Applications: Radio

You can switch between FM and DAB radio types in System Settings. Function keys for DAB radio feature Search and Reset keys instead of Scan forward and Scan back.





-  **Menu**
 - opens main menu,
 - long press is a shortcut to default application from other apps
-  **Map shortcut**
 - opens Map application
-  **On/Off**
 - switches radio on and off
-  **Scan forward**
 - scans radio channels
-  **Scan back**
 - scans radio channels

Radio application has slots for saving your favorite FM radio channels. To save the now playing channel, tap on a + icon at the end of an empty slot. To remove a saved channel, tap on the - icon at the end of the channel's name.

Applications: Weather

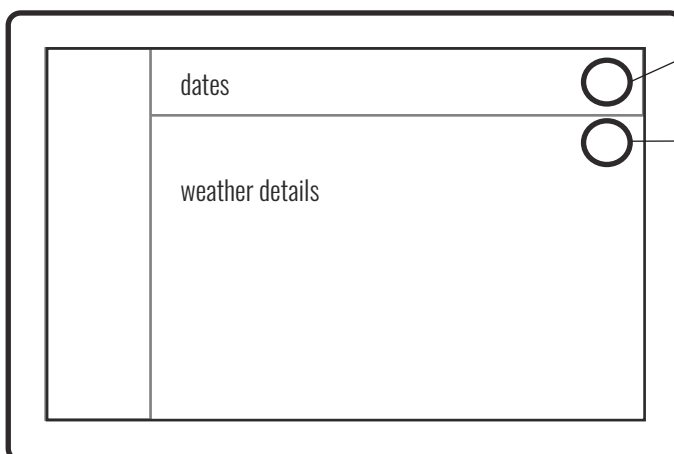
If you want the Q system to display real-time weather warnings, go to Alarms in Settings application and check the Weather warnings checkbox.



-  **Menu**
 - opens main menu,
 - long press is a shortcut to default application from other apps
-  **Map shortcut**
 - opens Map application

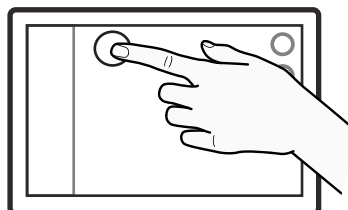

1 Changing date

To view forecast for different dates, simply tap on any of the available dates.

Applications: Guides

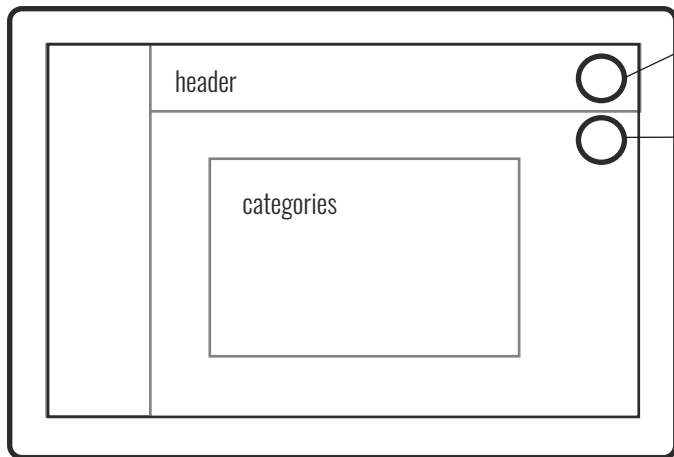

Menu

- opens main menu,
- long press is a shortcut to default application from other apps

Map shortcut

- opens Map application

Guides application contains boat's manuals and other supportive material. These can be either written documents or video tutorials. Available categories are listed on the Guides main page; tap on one to open it. Then select a topic on the opening sub page by tapping on it.

Video player:

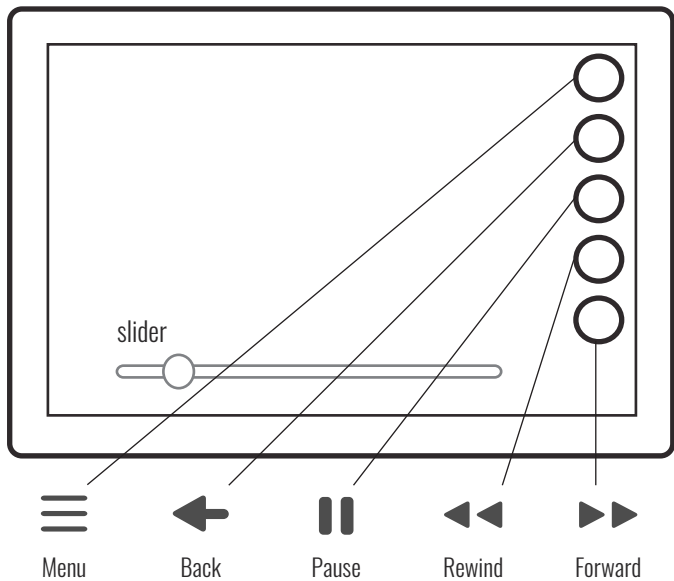

Documents:

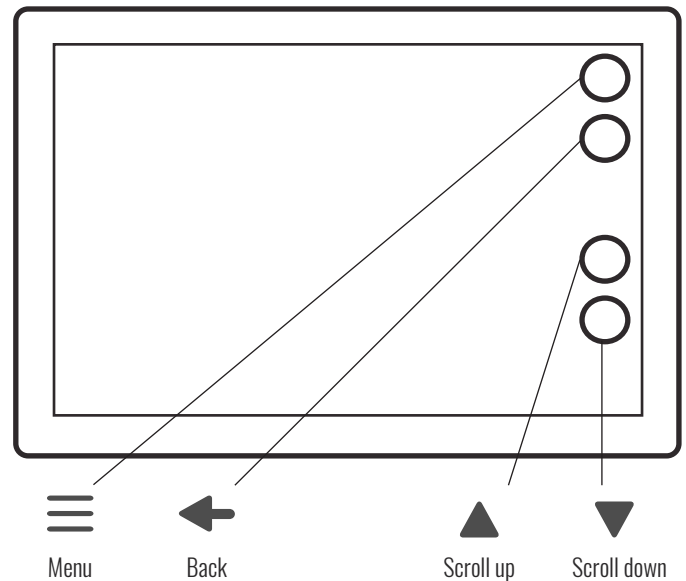

Applications: Settings

Settings contains a variety of adjustments and functions from Map's detail level to pairing a Bluetooth device. You can access Settings through the main menu.

1 System

All system's general settings can be found in System settings. These include language, time zone, date format and radio type. Here you can also reset to factory settings.

3 Units

Here you can change all the system's units, e.g. speed, depth and direction according to your preference.

5 Connectivity

In Connectivity settings you can e.g. change Wireless network mode or Bluetooth pair a device. Also pairing a Q Remote is done here.

7 Display

In Display setting you will find adjustments related to display, e.g. automatic/manual display brightness.

2 Boat

In Boat settings you will find boat related settings such as fuel sensor type. Here you can also find extra packages (e.g. media) that you need to go activate after resetting to factory settings.

4 Navigation

Navigation settings contain all navigation related settings, e.g. chart orientation and map's default zoom level. Here you can also view GPS information and adjust map's detail level.

6 Alarms

Alarm settings contain all alarm related adjustments. You can e.g. select if you want to get shallow and weather warnings by checking the corresponding checkboxes. Here you can also activate and deactivate the startup check.

Applications: Boat Heater

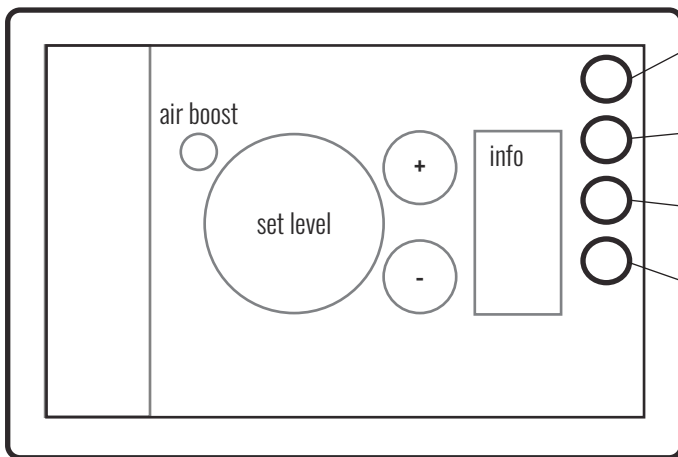

- Menu**
 - opens main menu,
 - long press is a shortcut to default application from other apps
- Map shortcut**
 - opens Map application
- Heater settings**
 - access Heater information and changing heater mode (if supported)
- On/Off**
 - long press turns the heater on and off

If your boat has a heater installed, you'll find a Heater app on your Q Panel. In addition to the application, the heater also has its own control panel. Changes made on control panel update to Heater application in real time.

Applications: Boat Controls

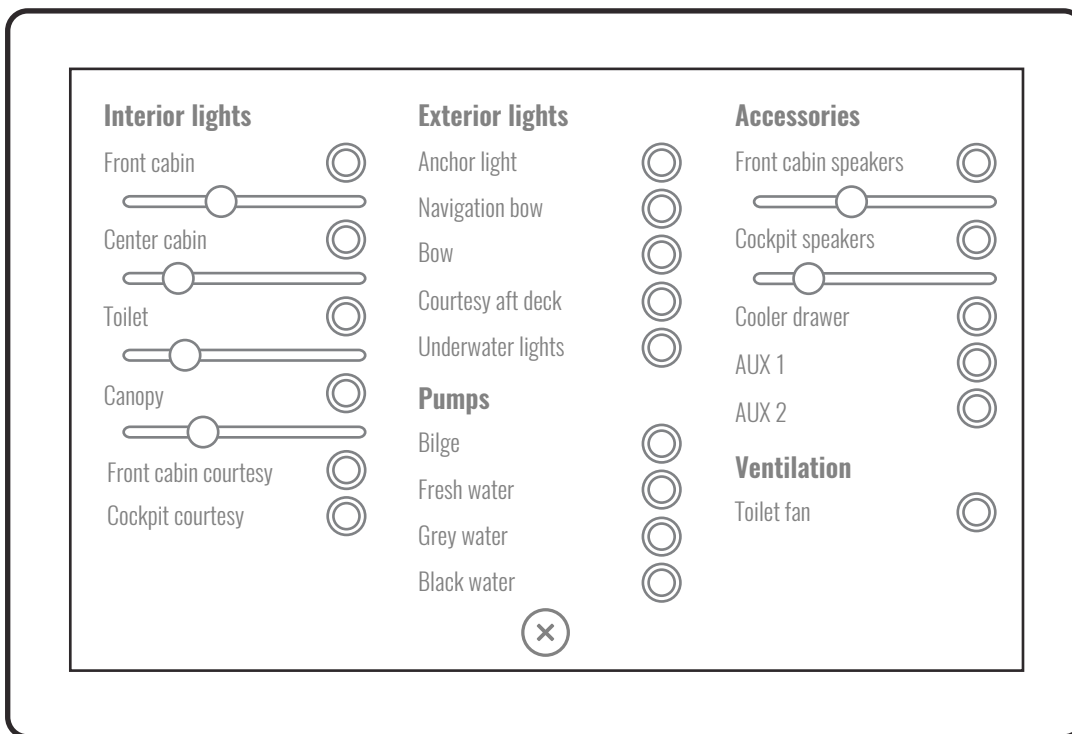

You can control boat's lighting, pumps and other accessories on Q system's Boat Controls application. The app contains simple on/off controls for each appliance and sliders for some appliances, e.g. stereo. Note that Boat Controls are only available in your boat if it has the Q Switch installed.

Boat Controls are always accessible through a tab at the top of the screen. You can open the app quickly regardless of which app you are currently using.

1 Tap on Boat Controls icon to open the application.

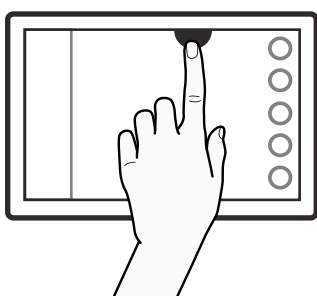

2 Application slides over the screen automatically.

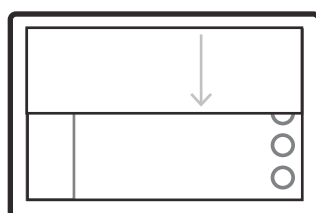

3 Tap on controls to turn appliances on and off.

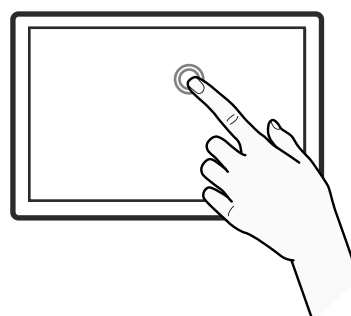

4 Tap on the X icon to close Boat Controls.

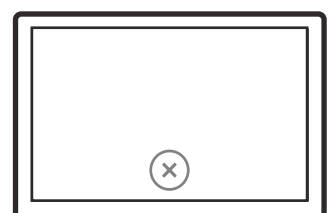

The Experience



www.theQexperience.com



The Q Experience



@qexperience